

KS B1503 FLANGE STANDARD 5K

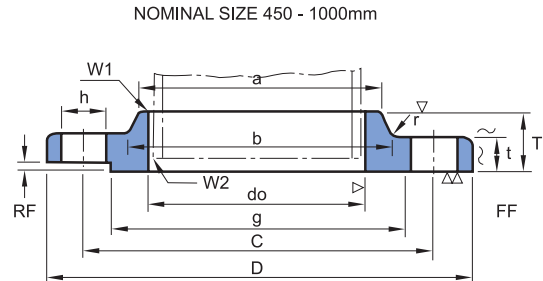
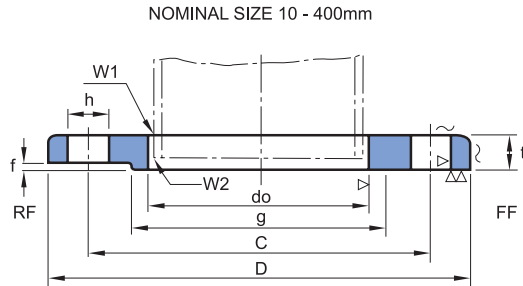

Unit : mm

| Nominal Dia. of Flange | Outside Dia. of Flange D | Sectional Dimensions of flange | | | | | | | | | | | Nominal Bolt Size | Welding | | |
|------------------------|--------------------------|--------------------------------|-----------------------|--------------------------|---------------------------------|----|----|-------------|------|-----------|---------------|-------------|-------------------|----------------------|------|-----|
| | | Dia. of Bolt Circle C | Dia. of Raised Face g | Inside Dia. of Flange do | Outside Dia. of Applicable pipe | t | T | Dia. of Hub | | Radi-us r | Raised Face f | Hole Dia. h | | Number of Bolt Holes | W1 | W2 |
| | | | | | | | | a | b | | | | | | | |
| (10) | 75 | 55 | 39 | 17.8 | 17.3 | 9 | - | - | - | - | 1 | 12 | 4 | M10 | 5.0 | 2.5 |
| 15 | 80 | 60 | 44 | 22.2 | 21.7 | 9 | - | - | - | - | 1 | 12 | 4 | M10 | 5.0 | 3.0 |
| (20) | 85 | 65 | 49 | 27.7 | 27.2 | 10 | - | - | - | - | 1 | 12 | 4 | M10 | 5.0 | 3.0 |
| 25 | 95 | 75 | 59 | 34.5 | 34.0 | 10 | - | - | - | - | 1 | 12 | 4 | M10 | 5.0 | 3.0 |
| (32) | 115 | 90 | 70 | 43.2 | 42.7 | 12 | - | - | - | - | 2 | 15 | 4 | M12 | 6.0 | 3.0 |
| 40 | 120 | 95 | 75 | 49.1 | 48.6 | 12 | - | - | - | - | 2 | 15 | 4 | M12 | 6.0 | 3.0 |
| 50 | 130 | 105 | 85 | 61.1 | 60.5 | 14 | - | - | - | - | 2 | 15 | 4 | M12 | 6.0 | 3.0 |
| 65 | 155 | 130 | 110 | 77.1 | 76.3 | 14 | - | - | - | - | 2 | 15 | 4 | M12 | 6.0 | 4.0 |
| 80 | 180 | 145 | 121 | 90.0 | 89.1 | 14 | - | - | - | - | 2 | 19 | 4 | M16 | 6.0 | 4.0 |
| (90) | 190 | 155 | 131 | 102.6 | 101.6 | 14 | - | - | - | - | 2 | 19 | 4 | M16 | 6.0 | 4.0 |
| 100 | 200 | 165 | 141 | 115.4 | 114.3 | 16 | - | - | - | - | 2 | 19 | 8 | M16 | 7.0 | 4.0 |
| 125 | 235 | 200 | 176 | 141.2 | 139.8 | 16 | - | - | - | - | 2 | 19 | 8 | M16 | 7.0 | 4.0 |
| 150 | 265 | 230 | 206 | 166.6 | 165.2 | 18 | - | - | - | - | 2 | 19 | 8 | M16 | 7.0 | 5.0 |
| (175) | 300 | 260 | 232 | 192.1 | 190.7 | 18 | - | - | - | - | 2 | 23 | 8 | M20 | 7.5 | 5.0 |
| 200 | 320 | 280 | 252 | 218.0 | 216.3 | 20 | - | - | - | - | 2 | 23 | 8 | M20 | 8.5 | 6.0 |
| (225) | 345 | 305 | 277 | 243.7 | 241.8 | 20 | - | - | - | - | 2 | 23 | 12 | M20 | 9.0 | 6.0 |
| 250 | 385 | 345 | 317 | 269.5 | 267.4 | 22 | - | - | - | - | 2 | 23 | 12 | M20 | 10.0 | 6.0 |
| 300 | 430 | 390 | 360 | 321.0 | 318.5 | 22 | - | - | - | - | 3 | 23 | 12 | M20 | 10.0 | 6.0 |
| 350 | 480 | 435 | 403 | 358.1 | 355.6 | 24 | - | - | - | - | 3 | 25 | 12 | M22 | 12.0 | 7.0 |
| 400 | 540 | 495 | 463 | 409.0 | 406.4 | 24 | - | - | - | - | 3 | 25 | 16 | M22 | 12.0 | 7.0 |
| 450 | 605 | 555 | 523 | 460.0 | 457.2 | 24 | 40 | 495 | 500 | 5 | 3 | 25 | 16 | M22 | 12.0 | 7.0 |
| 500 | 655 | 605 | 573 | 511.0 | 508.0 | 24 | 40 | 546 | 552 | 5 | 3 | 25 | 20 | M22 | 12.0 | 7.0 |
| 550 | 720 | 665 | 630 | 562.0 | 558.8 | 26 | 42 | 597 | 603 | 5 | 3 | 27 | 20 | M24 | 12.0 | 7.0 |
| 600 | 770 | 715 | 680 | 613.0 | 609.6 | 26 | 44 | 648 | 654 | 5 | 3 | 27 | 20 | M24 | 12.0 | 7.0 |
| 650 | 825 | 770 | 735 | 664.0 | 660.4 | 26 | 48 | 702 | 708 | 5 | 3 | 27 | 24 | M24 | 12.0 | 7.0 |
| 700 | 875 | 820 | 785 | 715.0 | 711.2 | 26 | 48 | 751 | 758 | 5 | 3 | 27 | 24 | M24 | 12.0 | 7.0 |
| 750 | 945 | 880 | 840 | 766.0 | 762.0 | 28 | 52 | 802 | 810 | 5 | 3 | 33 | 24 | M30 | 12.0 | 7.0 |
| 800 | 995 | 930 | 890 | 817.0 | 812.8 | 28 | 52 | 854 | 862 | 5 | 3 | 33 | 24 | M30 | 13.0 | 8.0 |
| 850 | 1045 | 980 | 940 | 868.0 | 863.6 | 28 | 54 | 904 | 912 | 5 | 3 | 33 | 24 | M30 | 13.0 | 8.0 |
| 900 | 1095 | 1030 | 990 | 919.0 | 914.4 | 30 | 56 | 956 | 964 | 5 | 3 | 33 | 24 | M30 | 13.0 | 8.0 |
| 1000 | 1195 | 1130 | 1090 | 1021.0 | 1016.0 | 32 | 60 | 1058 | 1066 | 5 | 3 | 33 | 28 | M30 | 14.0 | 9.0 |
| *(1100) | 1305 | 1240 | 1200 | 1123.0 | 1117.6 | 32 | - | - | - | - | 3 | 33 | 28 | M30 | | |
| *1200 | 1420 | 1350 | 1305 | 1225.0 | 1219.2 | 34 | - | - | - | - | 3 | 33 | 32 | M30 | | |
| *1350 | 1575 | 1505 | 1460 | - | 1371.6 | 34 | - | - | - | - | 3 | 33 | 32 | M30 | | |
| *1500 | 1730 | 1660 | 1615 | - | 1524.0 | 36 | - | - | - | - | 3 | 33 | 36 | M30 | | |

NOTE:

1. Flanges of parenthesized nominal diameter (), not to be used unless otherwise noted by purchaser.
2. The facing of flanges shall conform to KS B1519 (JIS B2202)
3. Nominal diameter over 1000 is manufacturer's standard (*)