

JIS B2220 FLANGE STANDARD 10K

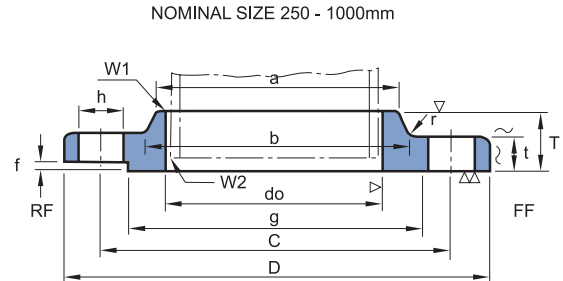
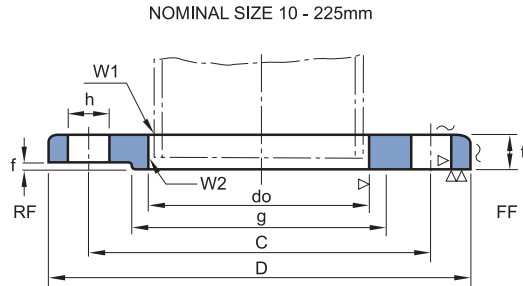

Unit : mm

Nominal Dia. of Flange	Outside Dia. of Flange D	Sectional Dimensions of flange												Nominal Bolt Size	Welding	
		Dia. of Bolt Circle C	Dia. of Raised Face g	Inside Dia. of Flange do	Outside Dia. of Applicable pipe	t	T	Dia. of Hub		Radi-us r	Raised Face f	Hole Dia. h	Number of Bolt Holes		W1	W2
								a	b							
10	90	65	46	17.8	17.3	12	-	-	-	-	1	15	4	M12	5	2.5
15	95	70	51	22.2	21.7	12	-	-	-	-	1	15	4	M12	5	3
20	100	75	56	27.7	27.2	14	-	-	-	-	1	15	4	M12	5	3
25	125	90	67	34.5	34	14	-	-	-	-	1	19	4	M16	5	3
32	135	100	76	43.2	42.7	16	-	-	-	-	2	19	4	M16	6	3
40	140	105	81	49.1	48.6	16	-	-	-	-	2	19	4	M16	6	3
50	155	120	96	61.1	60.5	16	-	-	-	-	2	19	4	M16	6	3
65	175	140	116	77.1	76.3	18	-	-	-	-	2	19	4	M16	6.5	4
80	185	150	126	90	89.1	18	-	-	-	-	2	19	8	M16	6.5	4
(90)	195	160	136	102.6	101.6	18	-	-	-	-	2	19	8	M16	6.5	4
100	210	175	151	115.4	114.3	18	-	-	-	-	2	19	8	M16	7	4
125	250	210	182	141.2	139.8	20	-	-	-	-	2	23	8	M20	7.5	4
150	280	240	212	166.6	165.2	22	-	-	-	-	2	23	8	M20	8	5
(175)	305	265	237	192.1	190.7	22	-	-	-	-	2	23	12	M20	9	5
200	330	290	262	218	216.3	22	-	-	-	-	2	23	12	M20	9	6
(255)	350	310	282	243.7	241.8	22	-	-	-	-	2	23	12	M20	9	6
250	400	355	324	269.5	267.4	24	36	288	292	6	2	25	12	M22	10	6
300	445	400	368	321	318.5	24	38	340	346	6	3	25	16	M22	10	6
350	490	445	413	358.1	355.6	26	42	380	386	6	3	25	16	M22	12	7
400	560	510	475	409	406.4	28	44	436	442	6	3	27	16	M24	12	7
450	620	565	530	460	457.2	30	48	496	502	6	3	27	20	M24	14	8
500	675	620	585	511	508	30	48	548	554	6	3	27	20	M24	14	8
550	745	680	640	562	558.8	32	52	604	610	6	3	33	20	M30	15	9
600	795	730	690	613	609.6	32	52	656	662	6	3	33	24	M30	16	10
650	845	780	740	664	660.4	34	56	706	712	6	3	33	24	M30	16	10
700	905	840	800	715	711.2	34	58	762	770	6	3	33	24	M30	17	10
750	970	900	855	766	762	36	62	816	824	6	3	33	24	M30	18	11
800	1020	950	905	817	812.8	36	64	868	876	6	3	33	28	M30	19	12
(850)	1070	1000	955	868	863.6	36	66	920	928	6	3	33	28	M30	19	12
900	1120	1050	1005	919	914.4	38	70	971	979	6	3	33	28	M30	22	14
1000	1235	1160	1110	1021	1016	40	74	1073	1081	6	3	39	28	M36	22	14
*(1100)	1345	1270	1220	1123	1117.6	42	-	-	-	-	3	39	28	M36		
*1200	1465	1380	1325	1225	1219.2	44	-	-	-	-	3	39	32	M36		
*1350	1630	1540	1480	-	1371.6	48	-	-	-	-	3	45	36	M42		
*1500	1795	1700	1635	-	1524.0	50	-	-	-	-	3	45	40	M42		

NOTE:

1. Flanges of parenthesized nominal diameter () , not to be used unless otherwise noted by purchaser.
2. The facing of flanges shall conform to KS B1519 (JIS B2202)
3. Nominal diameter over 1000 is manufacturer's standard (*)